



# Parks and Recreation Board Meeting

Wednesday, June 16, 2021 at 6:00 pm

1. CALL TO ORDER, PRAYER AND PLEDGE
2. ROLL CALL
3. ADDITIONS/DELETIONS/CHANGES
4. CONSENT AGENDA
  - a. **Approval of Minutes of 04/21/2021**  
Exhibit: Agenda Report Number 4a

**Attachments:**

- **Agenda Report Number 4a** (Agenda\_Report\_Number\_4a.pdf)

5. PRESENTATIONS
6. ACTION ITEMS
7. PUBLIC COMMENTS
8. DISCUSSION
  - a. **Update on Playground Purchase**  
Exhibit: Agenda Report Number 8a

**Attachments:**

- **Agenda Report Number 8a** (Agenda\_Report\_Number\_8a\_2021061611192832.pdf)

- b. **Pavilion at Corey Rd**  
volunteer to pursue Home Depot Community Grant they are doing some grants now.  
Exhibit: Agenda Report Number 8b

**Attachments:**

- **Agenda Report Number 8b** (Agenda\_Report\_Number\_8b.pdf)

9. OLD/NEW BUSINESS
10. BOARD MEMBERS/STAFF REPORTS
11. ADJOURNMENT

The following draft minutes are subject to changes and/or revisions by the Park Board and shall not be considered the official minutes until approved by the Park Board.

**TOWN OF MALABAR – PARKS AND RECREATION ADVISORY BOARD  
April 21, 2021, MEETING MINUTES**

This meeting of the Malabar Parks and Rec Board was held at Town Hall at 2725 Malabar Road. It was called to order by Chair Eric Beinvenu at 6:00 pm. Prayer and pledge were led by Chair Eric Beinvenu.

**1. CALL TO ORDER, PRAYER AND PLEDGE**

**2. ROLL CALL**

<b>Chair</b>	Eric Bienvenu - Present
<b>Vice-Chair</b>	Vicky Thomas – Present
<b>Members</b>	Tom Taylor - Present Jennifer Bienvenu – Present Hans Kemmler - Present Parnel Jean - Present Evan Hall - Present

**Recording Secretary** Dorothy Carmel – Present

**Public** Annilee Harvey

**3. ADDITIONS/DELETIONS/CHANGES:**

**4. CONSENT AGENDA - Approved**

**5. APPROVAL OF MINUTES – February 17, 2021**

**VOTE: MOTION TO APPROVE Vote – Tabled due to page 1 missing, all Ayes.**

- 6. PRESENTATIONS:** Annilee Harvey would like to have a weekend market set up in front of the fire station. Would like to set up an adhoc committee to oversee it. Ms. Harvey would take it for the first year.

**VOTE: MOTION TO APPROVE Vote – J. Bienvenu/Thomas, all Ayes.**

**7. ACTION:**

**8. DISCUSSION:**

- a. **Playground update** – It was sent out for bids.
- b. **Look at Catalogs for ideas** – Have been submitted.
- c. **Pavilion at Corey Road** – Home Depot has a grant program.

**9. OLD/NEW BUSINESS:**

**New Business:**

**Old Business:**

**10. BOARD MEMBER/STAFF REPORTS:**

- **Richard E. Cameron & Volunteers Wilderness Preserve** – Thomas – very mucky, but good.
- **Disc Golf Sanctuary** – Kemmler – getting a lot of use.
- **Thomas Eschenberg Memorial Conservation Area** – Jean -
- **Malabar Community Park** – Taylor/ Bienvenu – looks good, keeping it mowed to the fence.
- **Sandhill Trail Head** – Bienvenu – getting used, there was a horse trailer in there.

**11. ADJOURNMENT**

There being no further discussion, general consensus. **MOTION:** motion to adjourn the meeting **Kemmler/Thomas VOTE:** All Ayes. This meeting adjourned at 7:00 pm.

By:

\_\_\_\_\_  
Eric Bienvenu, Chair

ATTEST:

\_\_\_\_\_  
Dorothy Carmel  
Recording Secretary

Date Approved: \_\_\_\_\_

**NOTE: THERE MAY BE ONE OR MORE MALABAR ELECTED OFFICIAL ATTENDING THIS MEETING**

If an individual decides to appeal any decision made by this board with respect to any matter considered at this meeting, a verbatim transcript may be required, and the individual may need to insure that a verbatim transcript of the proceedings is made (Florida Statute 286.0105). The Town does not provide this service. In compliance with the Americans With Disabilities Act (ADA), anyone who needs a special accommodation for this meeting should contact the Town's ADA Coordinator at 321-727-7764 at least 48 hours in advance of this meeting.

Town of Malabar  
 2725 Malabar Road  
 Malabar, FL 32950

# Purchase Order

Date	P.O. No.
5/12/2021	202125

<b>Vendor</b>
Top Line Recreation Inc. 2922 Howland Blvd. Ste 3 Deltona, FL 32725

<b>Ship To</b>
Town of Malabar 2725 Malabar Road Malabar, FL 32950

<b>Terms</b>
per proposal

--

Item	Description	Amount
Playground	Replacement grouping BCI Burke Intensity, Nucleus #134-139897-1 under St. Johns County School District #2018-04 Bid (Sales Unit NUNP-2986) Per Proposal Quote # TLRQ4107 Price includes Shipping, Installation and the BCI Burke Coastal Package Installation for mid to late August if approved before May 30th, 2021 50% due for Deposit and balance on October 1, 2021	96,252.54
Phone #		
<b>Total</b>		\$96,252.54

*[Handwritten Signature]* 5/14/2021

Top Line Recreation, Inc.  
 2922 HOWLAND BLVD -  
 SUITE 4  
 Deltona, FL 32725  
 (800)921-4509  
 soniap@toplinerec.com  
 http://www.toplinerec.com



MAY 20 2021 AM 8:42

# INVOICE

**BILL TO**  
 Debby Franklin  
 Town of Malabar  
 2725 Malabar Road  
 Malabar, FL 32950

**SHIP TO**  
 Debby Franklin  
 Town of Malabar  
 2725 Malabar Road  
 Malabar, FL 32950

**INVOICE #** 2853  
**DATE** 05/19/2021  
**DUE DATE** 05/19/2021  
**TERMS** 50% DEPOSIT

**SALES REP**  
 Tracy Gill

**CUSTOMER PO**  
 202125

**QUOTE**  
 TLRQ4107

ACTIVITY	QTY	RATE	AMOUNT
<b>BURKE</b> #134-139897-1 NUNP-2986	0.50	84,567.00	42,283.50
<b>STJOHN</b> 7.0% St Johns County Discount	0.50	-5,919.69	-2,959.85
<b>SPECPRICE</b> BCI Burke Special Pricing Discount	0.50	-23,848.31	-11,924.16
<b>BURKE</b> #134-139897-1 BASICS	0.50	2,838.00	1,419.00
<b>STJOHN</b> 7.0% St Johns County Discount	0.50	-198.66	-99.33
<b>COASTAL</b> Coastal Package	0.50	2,551.92	1,275.96
<b>BOSGRAAF</b> Installation by Bosgraaf & Sons	0.50	27,969.60	13,984.80

Thank you for your business!

**SUBTOTAL** 43,979.92  
**SHIPPING** 4,146.35  
**TOTAL** 48,126.27  
**BALANCE DUE** 48,126.27

A/P Approval/Payment Process

50% Deposit **\$48,126.27**

TC/Tr. & AP Clk: D. Franklin  
 TA: S. Noel 5/24  
 CM Reviewer: \_\_\_\_\_  
 Date Paid: 5/24/2021  
 Check #: 63063  
 Acct: 572,6400

**MALABAR PARK**

PROPOSAL #: 134-139897-1



**COLOR KEY**

●	LIME
●	TAN
●	BROWN
●	BROWN/TAN

**DESIGN**

**PURCHASE**

**CONSTRUCT**

**ENJOY**

**OZCO Project #209 -  
10x20 Pavilion  
6x6 Posts**

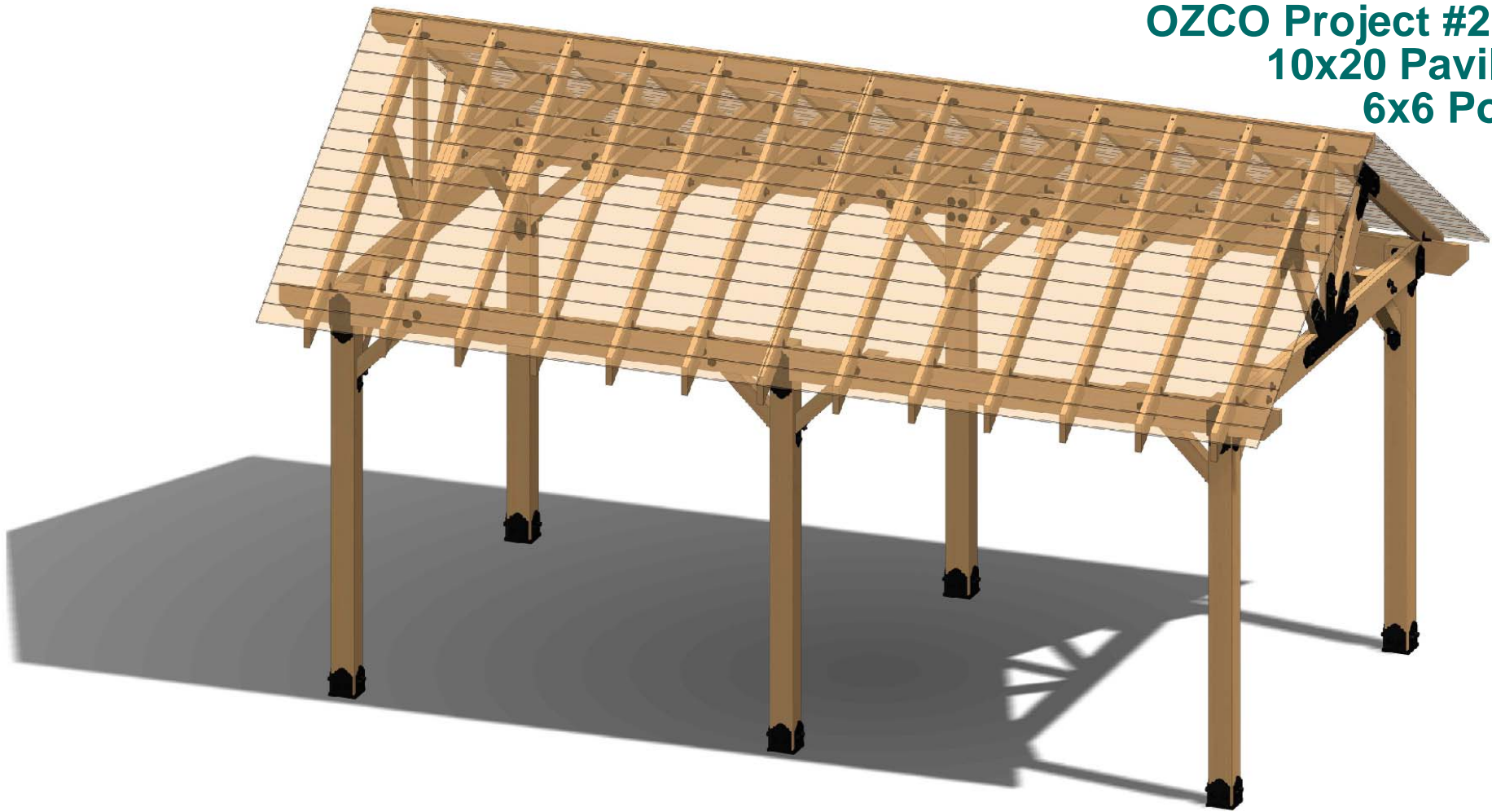

roofing shown translucent for clarity



**OZCO** BUILDING PRODUCTS



# Printing Documents from ISSUU

Unfortunately, there is currently no way to print content directly through issuu. To print a publication, you will need to download it and print it from your computer.

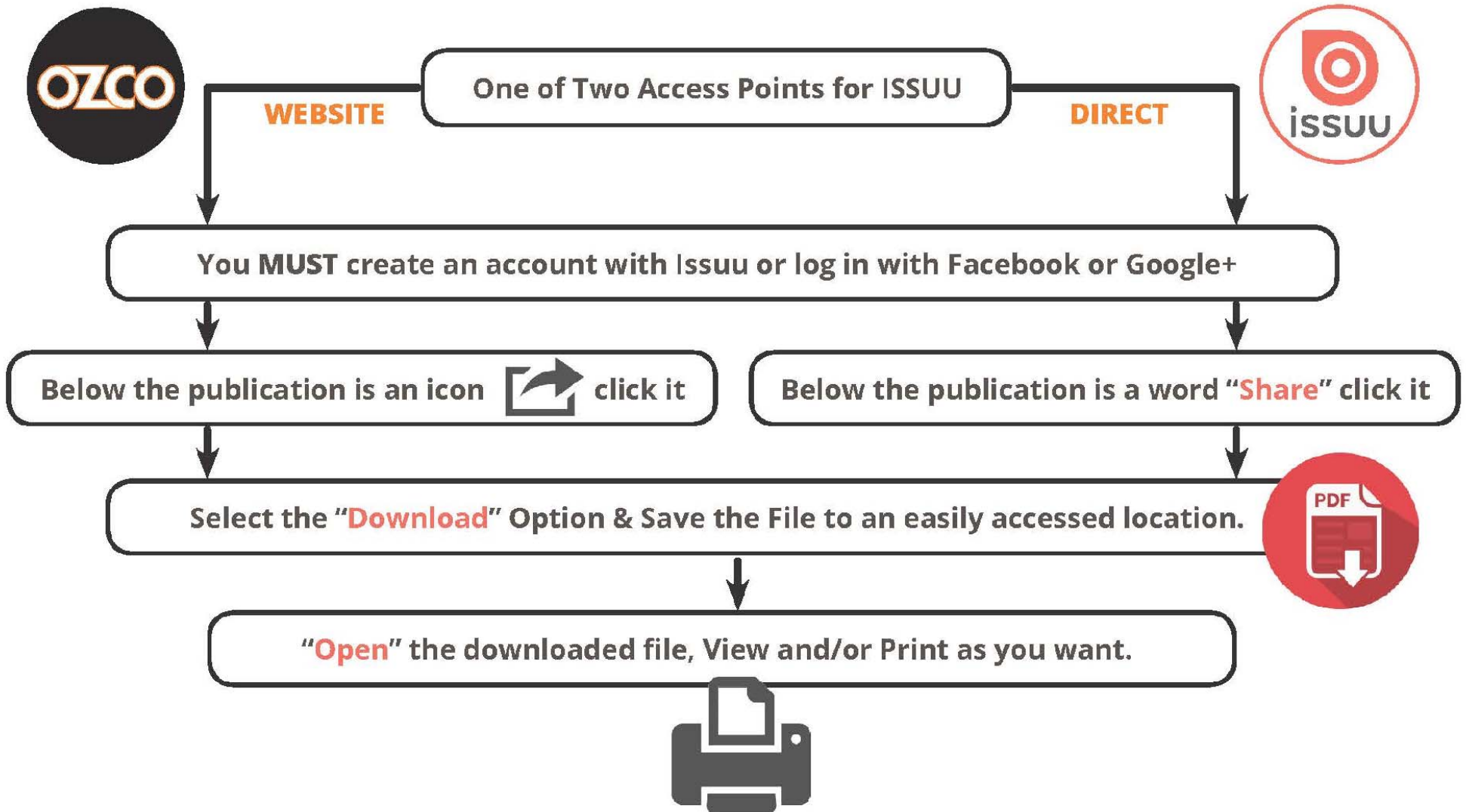



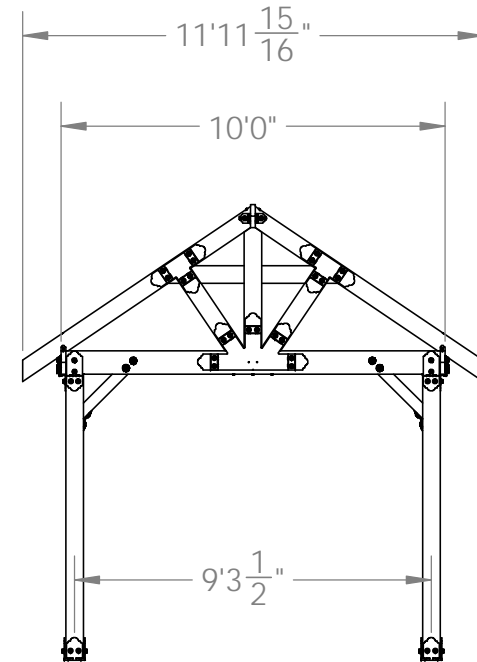
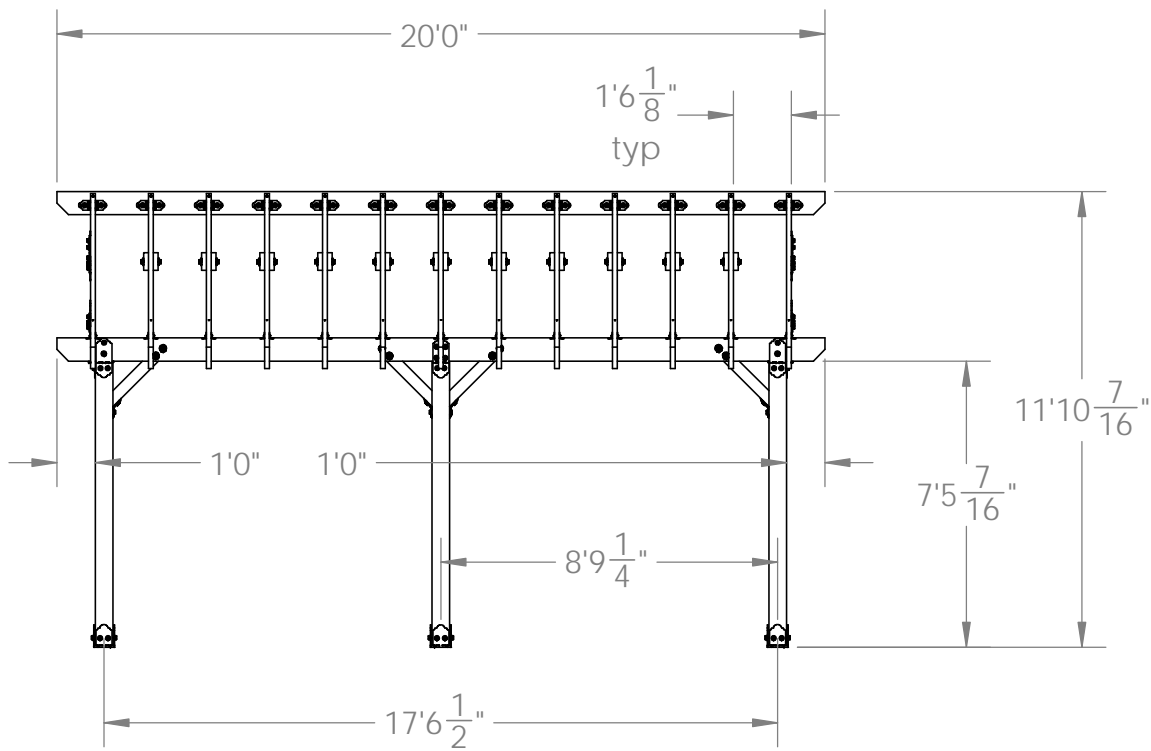

shown without roofing for clarity

## OZCO Project #209 - 10x20 Pavilion w 6x6 Posts

### Pavilion Overview

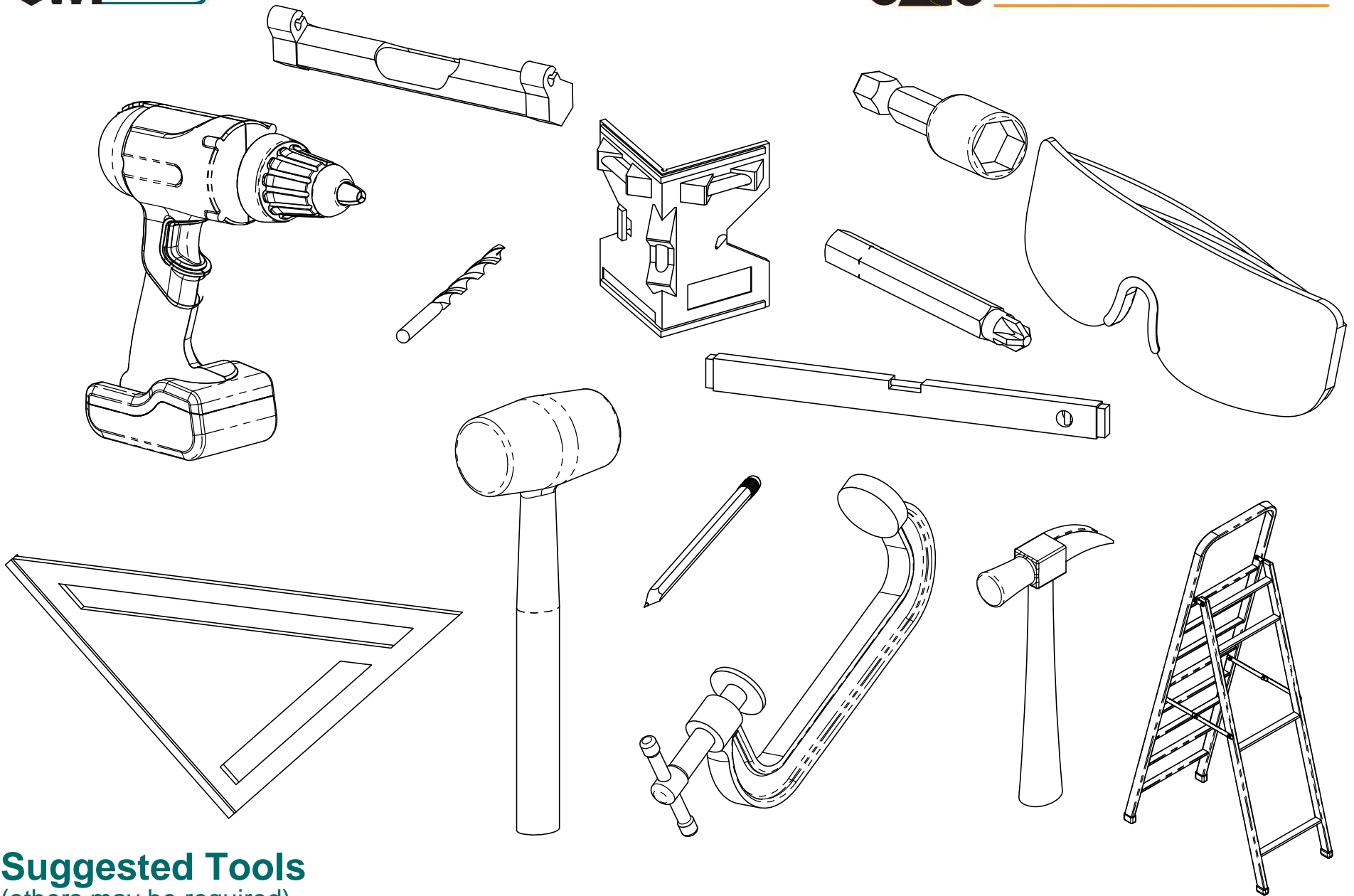

**Suggested Tools**  
(others may be required)

QTY.	PART NUMBER	DESCRIPTION
6	56608	6x6 Post Base (6x6-PB-LS)
4	56636	Post to Beam Bolt Offset (P2B-BO-LS)
1	56677	8" Post to Beam Coupler (P2B-SB-LS)
3	56668	4" Flush Inside 45 (FI45-LS-4)
24	56650	OWT Timber Bolt 6-8"
15	56680	2" Timber Bolt Heavy Duty Washer (OWT-TBW-2)
2	56619	Truss Base Fan 8:12
11	56611	Truss Accent (TA-LS)
2	56625	OWT Timber Screw 1-3/4"
2	56612	"T" Tie Plate (TTP)
11	56649	OWT Timber Bolt 4-6"
6	56617	2" Standard Rafter Clip (RC-LS-2)
6	56618	4" Standard Rafter Clip (RC-LS-4)
1	56647	OWT Timber Screw 10"
2	56627	OWT Timber Screw 3-3/4"
2	56629	OWT Timber Screw 7-1/2"
6	6x6x8L	6x6x8
4	4x4x10L	4x4x10
14	2x8x10L	2x8x10
2	2x6x10L	2x6x10
26	2x6x8L	2x6x8
22	2x6x6L	2x6x6

## Material List

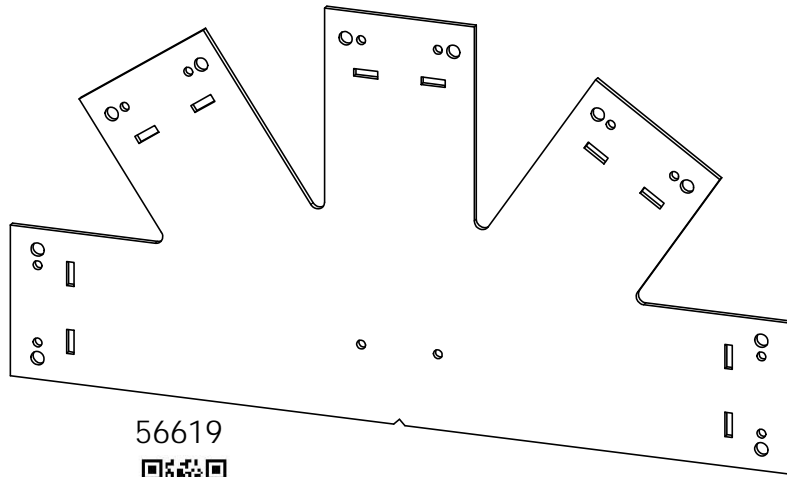

56619

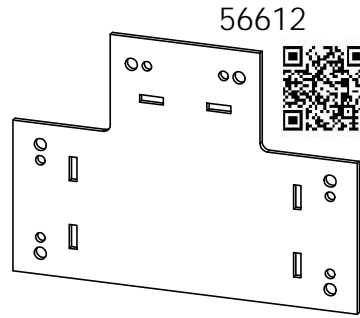

56612

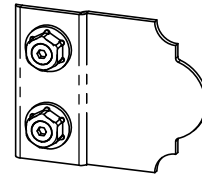

56611

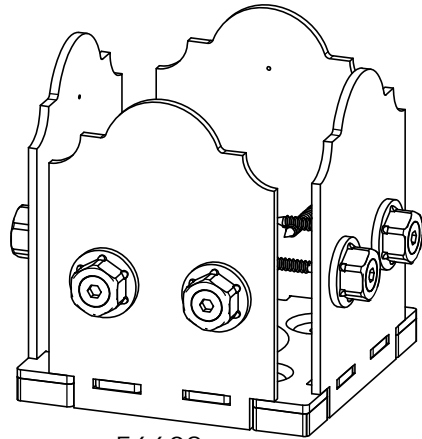

56608

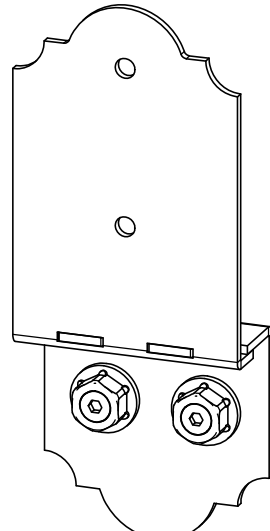

56636

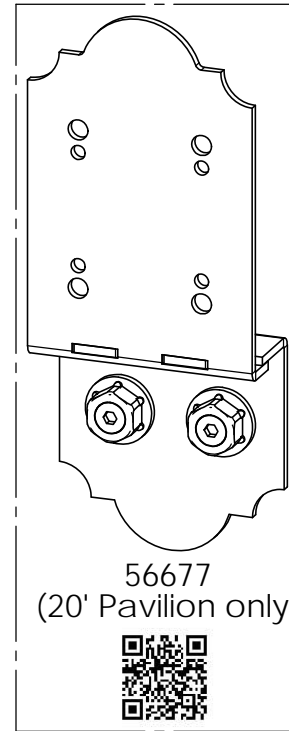

56677  
(20' Pavilion only)

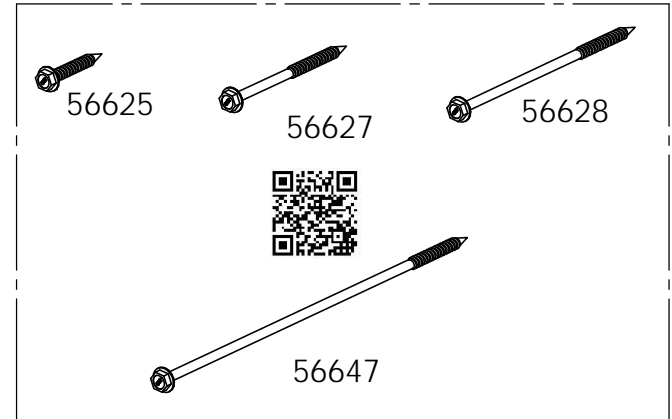

56625

56627

56628



56647



56650

56649



56618

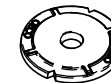
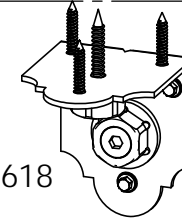

56680

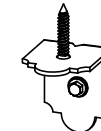

56617

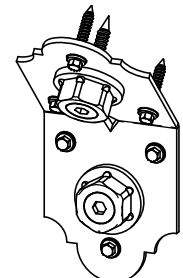

56668



**OZCO**

Scan QR barcode with smartphone for quick access to product installation instructions

Pavilion OZCO

# Laredo Sunset & Ironwood



Laredo Sunset  
(566XX series)

2 great styles  
Same functionality

choose your  
connection lifestyle

both styles available for  
most products

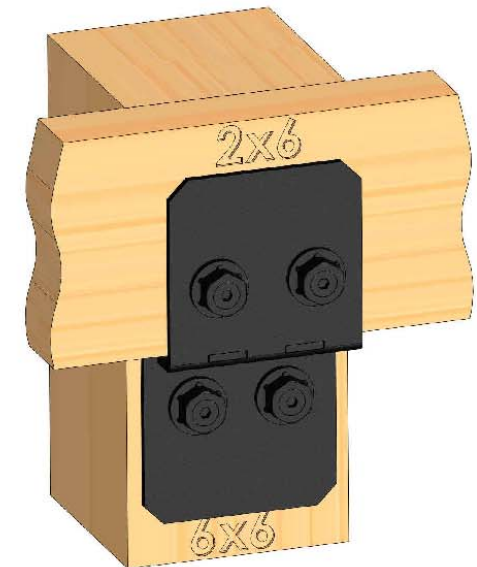

Ironwood  
(517XX series)



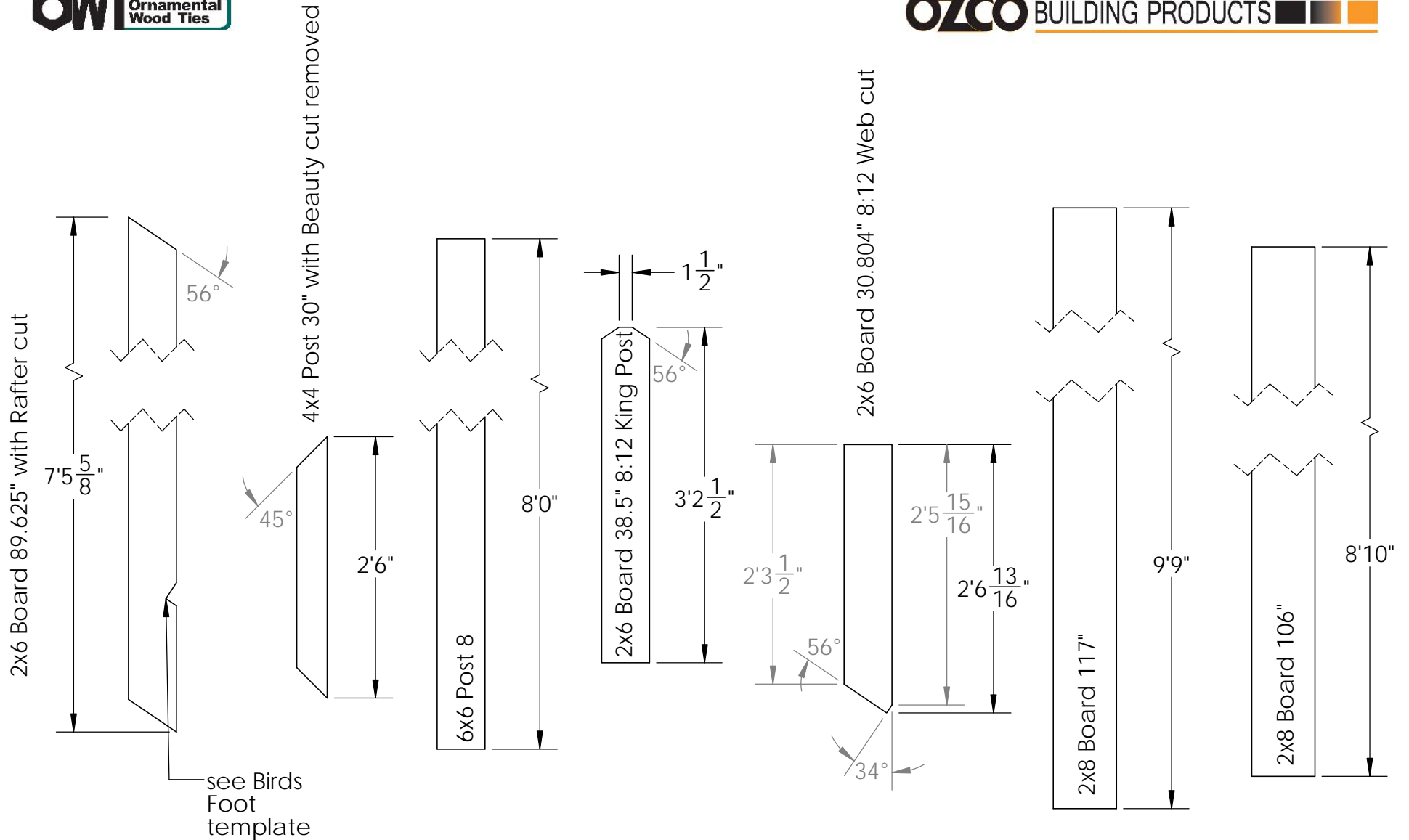

## 10x(length) Pavilion cut list: common to all 10' wide Pavilions

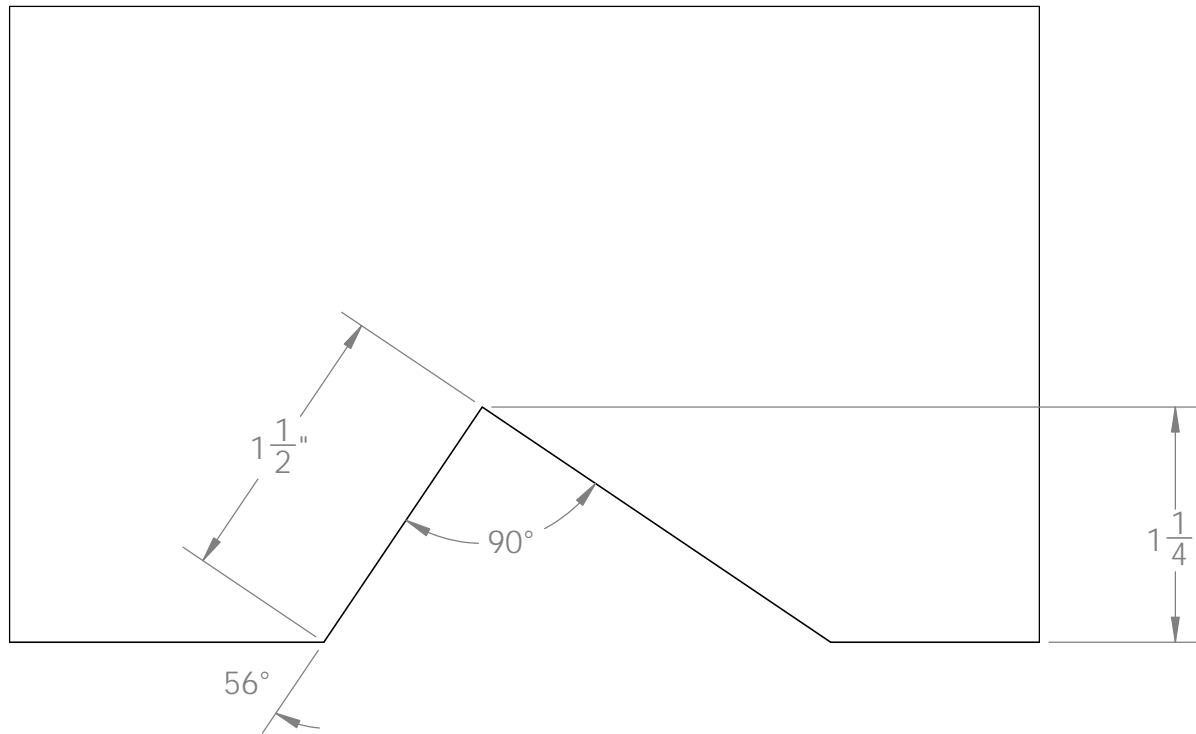
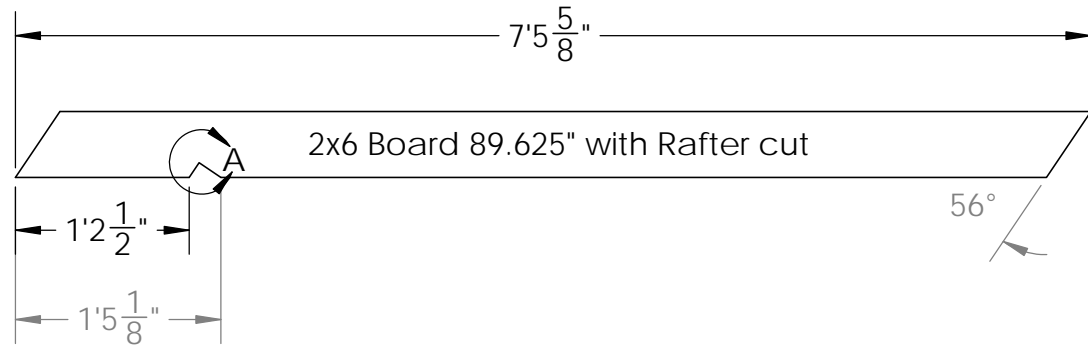

## Birds Foot 1:1 template

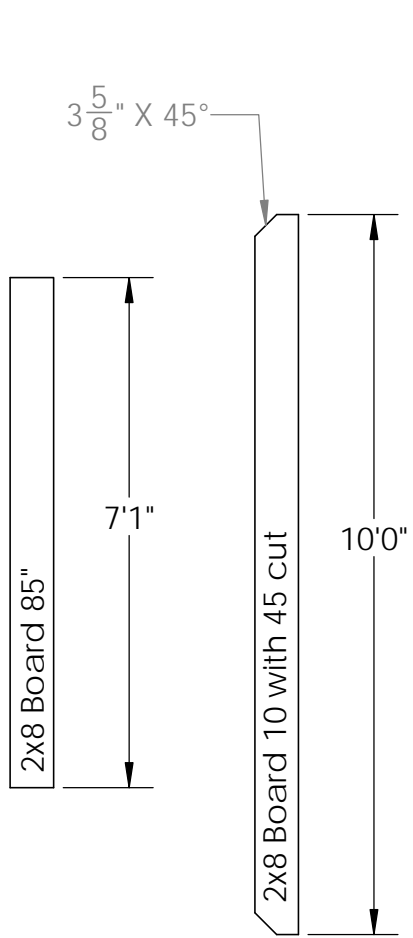

**10x10**

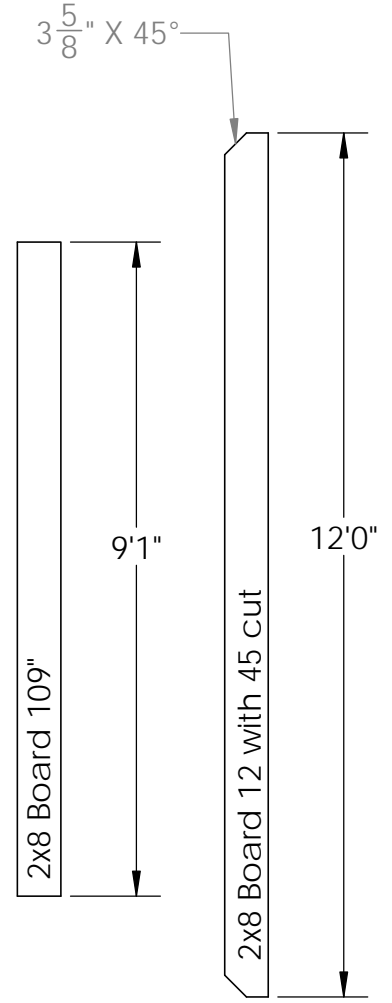

**10x12**

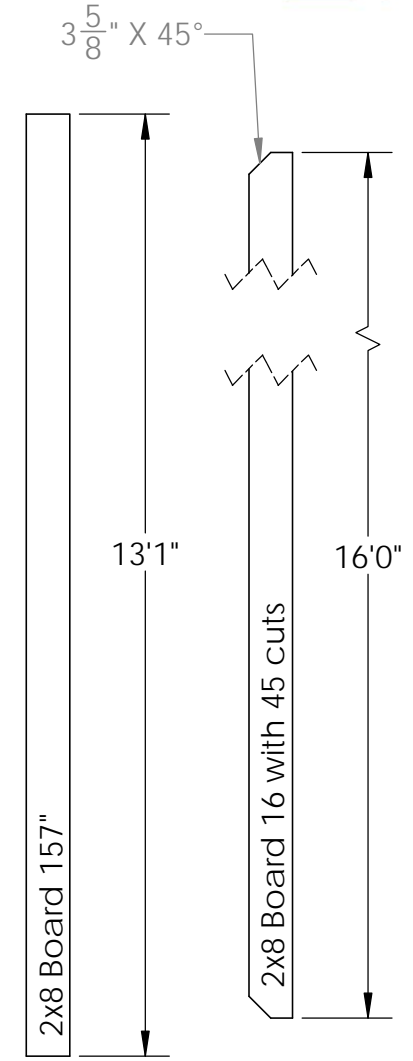

**10x16**

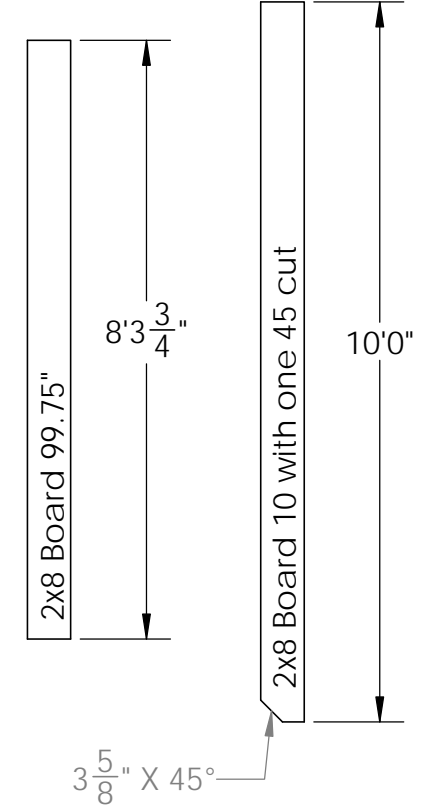

**10x20**

**10x(length) Pavilion cut list: 2x8 length wise boards**



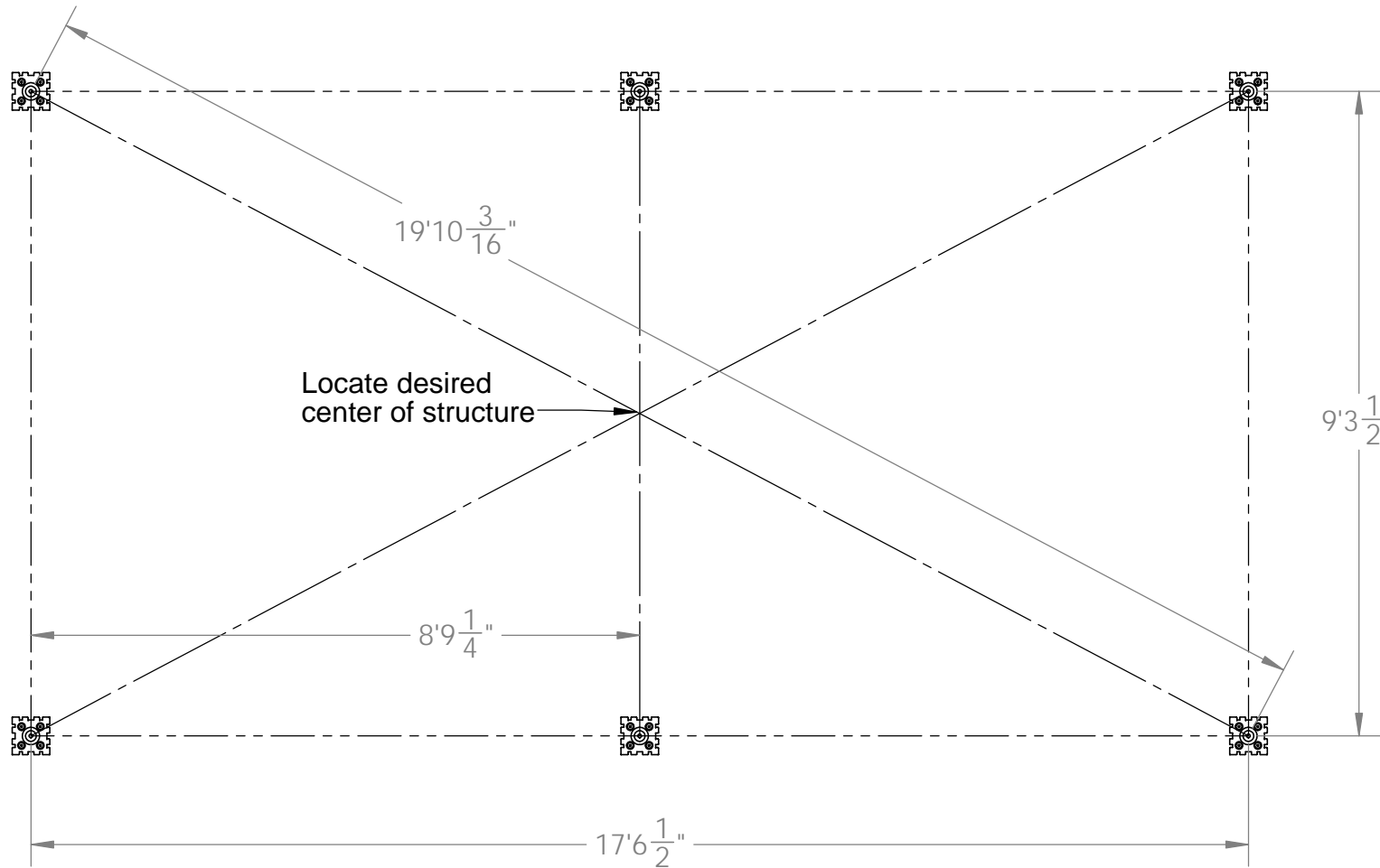

if site is not level, see Ozco Site Leveling instruction



## Site Plan - OZCO Project #209 - 10x20 Pavilion w 6x6 Posts

Pavilion Site Plan

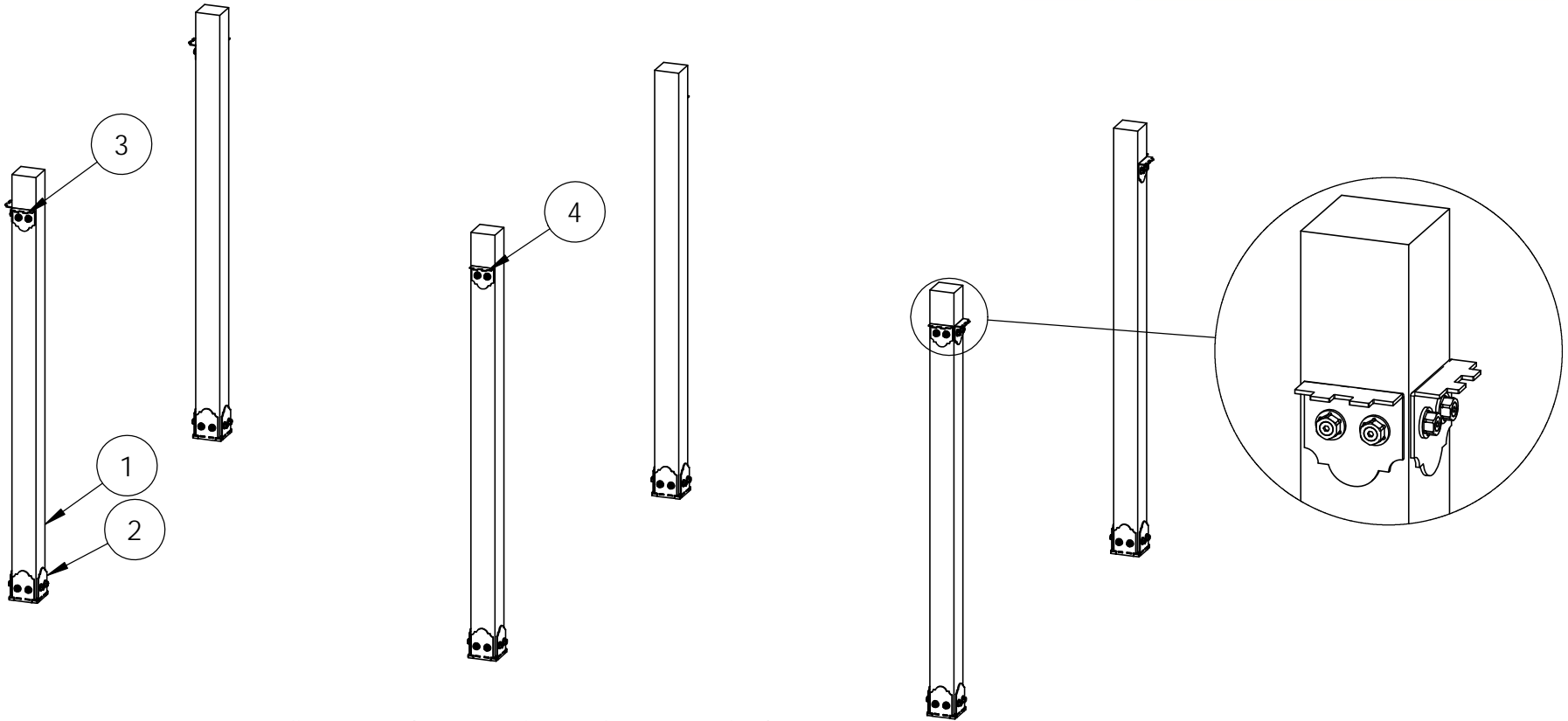

note: all post to beams share the same ledge

ITEM NO.	QTY.	PART NUMBER	DESCRIPTION
1	6	6x6 Post	6x6x8'0"
2	6	56608	6x6 Post Base Kit (6X6-PB-LS)
3	8	56636	Post to Beam Bolt Offset (P2B-BO-LS)
4	1	56677	8" Post to Beam Coupler (P2B-SB-LS)

## OZCO Project #209 - 10x20 Pavilion w 6x6 Posts ledge

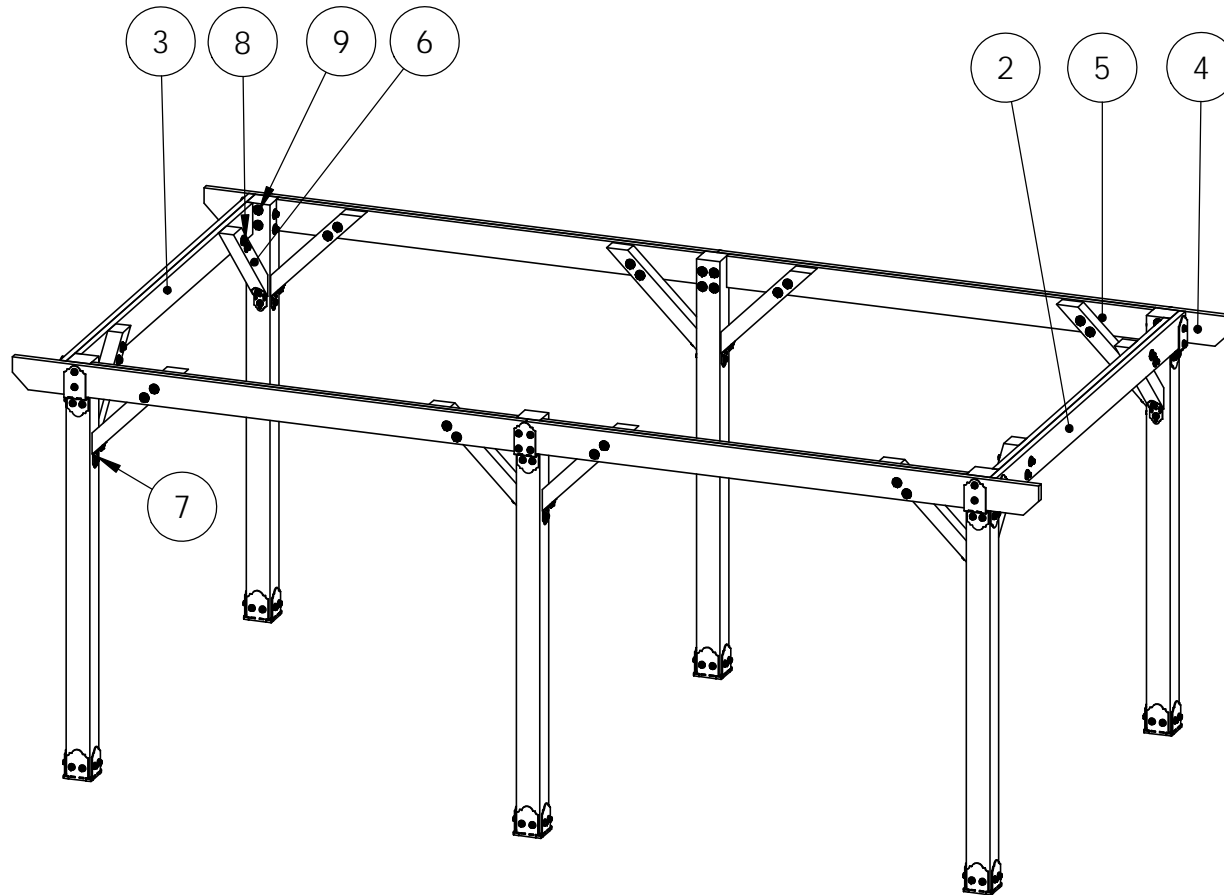

ITEM NO.	QTY.	PART NUMBER	DESCRIPTION
1	1	Pavilion Base	OZCO Project #209 - 10x20 Pavilion w 6x6 Posts
2	2	2x8 Board	2x8x9'9"
3	2	2x8 Board	2x8x8'10"
4	4	2x8 Board	2x8x10'0"
5	4	2x8 Board	2x8x8'3 3/4"
6	12	4x4 Post	4x4x2'6"
7	3	56668	4" Flush Inside 45 (FI45-LS-4)
8	12	56650	OWT Timber Bolt 6-8"
	12	56680	2" Timber Bolt Heavy Duty Washer (OWT-TBW-2)
9	12	56650	OWT Timber Bolt 6-8"
	6	56680	2" Timber Bolt Heavy Duty Washer (OWT-TBW-2)

## OZCO Project #209 - 10x20 Pavilion w 6x6 Posts

Pavilion Beam & Support

# Building your Canopy...

## Simple 3 step procedure common to all size Pavilions

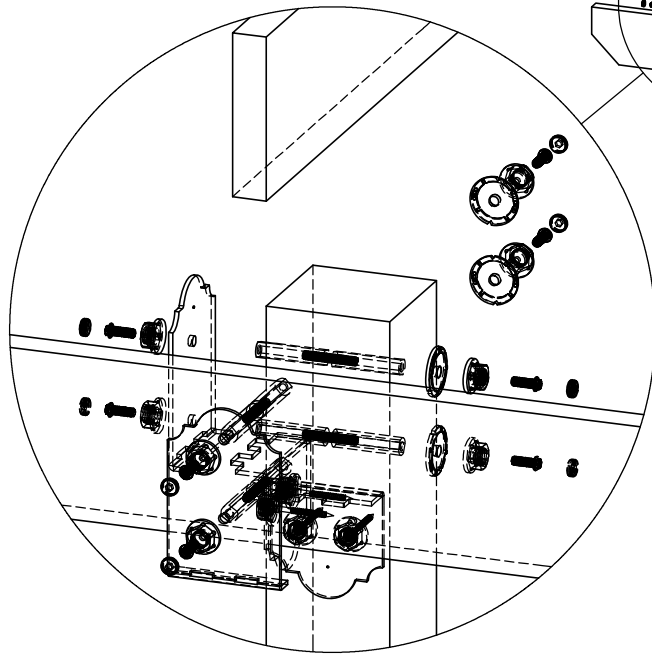

use this procedure for all size Pavilions (10x10 shown). same construction steps and techniques apply

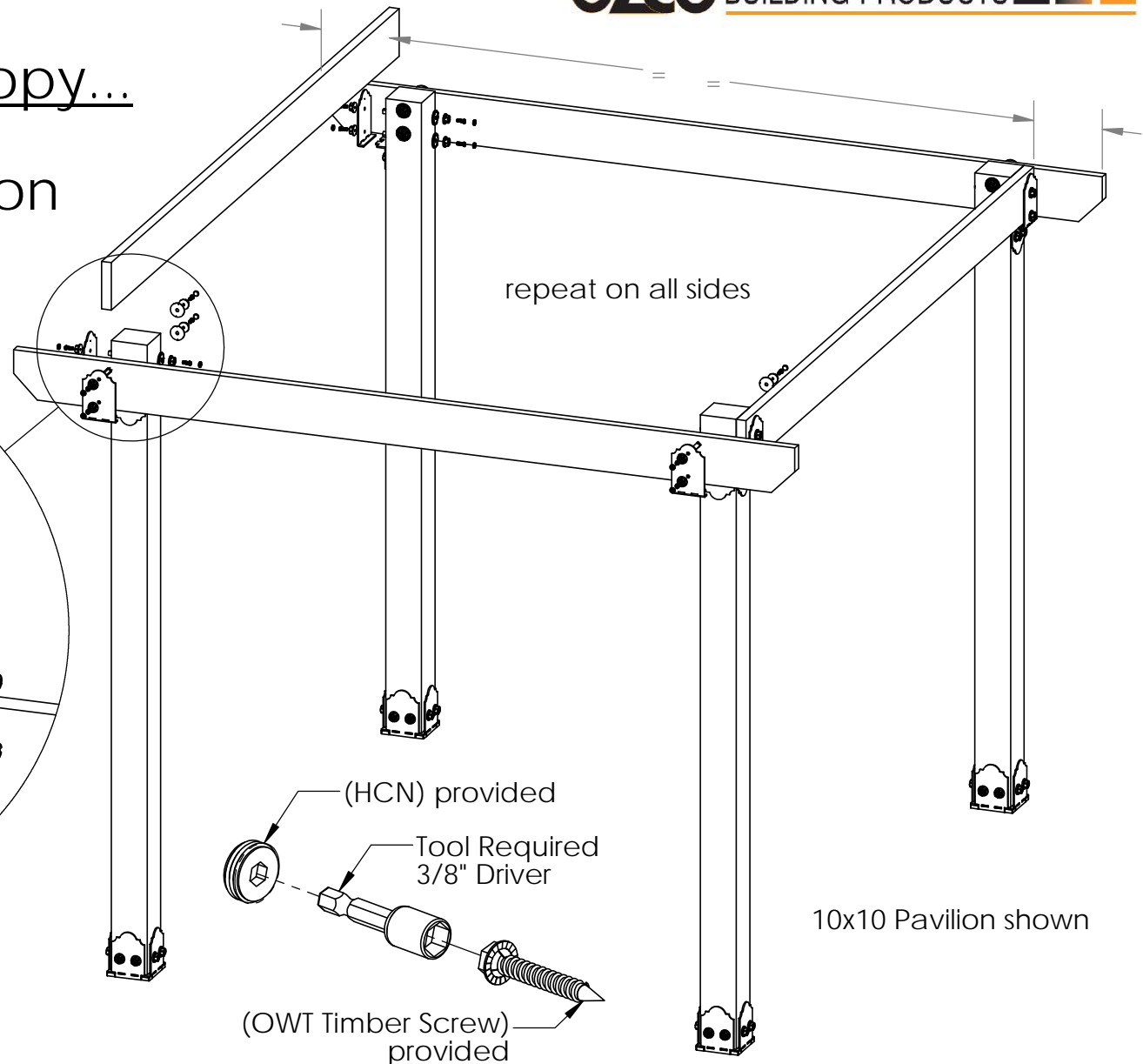

## step 1 Outer Beams

Pavilion Beam & Support

Secure with nails or screws  
Repeat on all sides

for additional beam rigidity  
apply polyurethane adhesive  
between boards

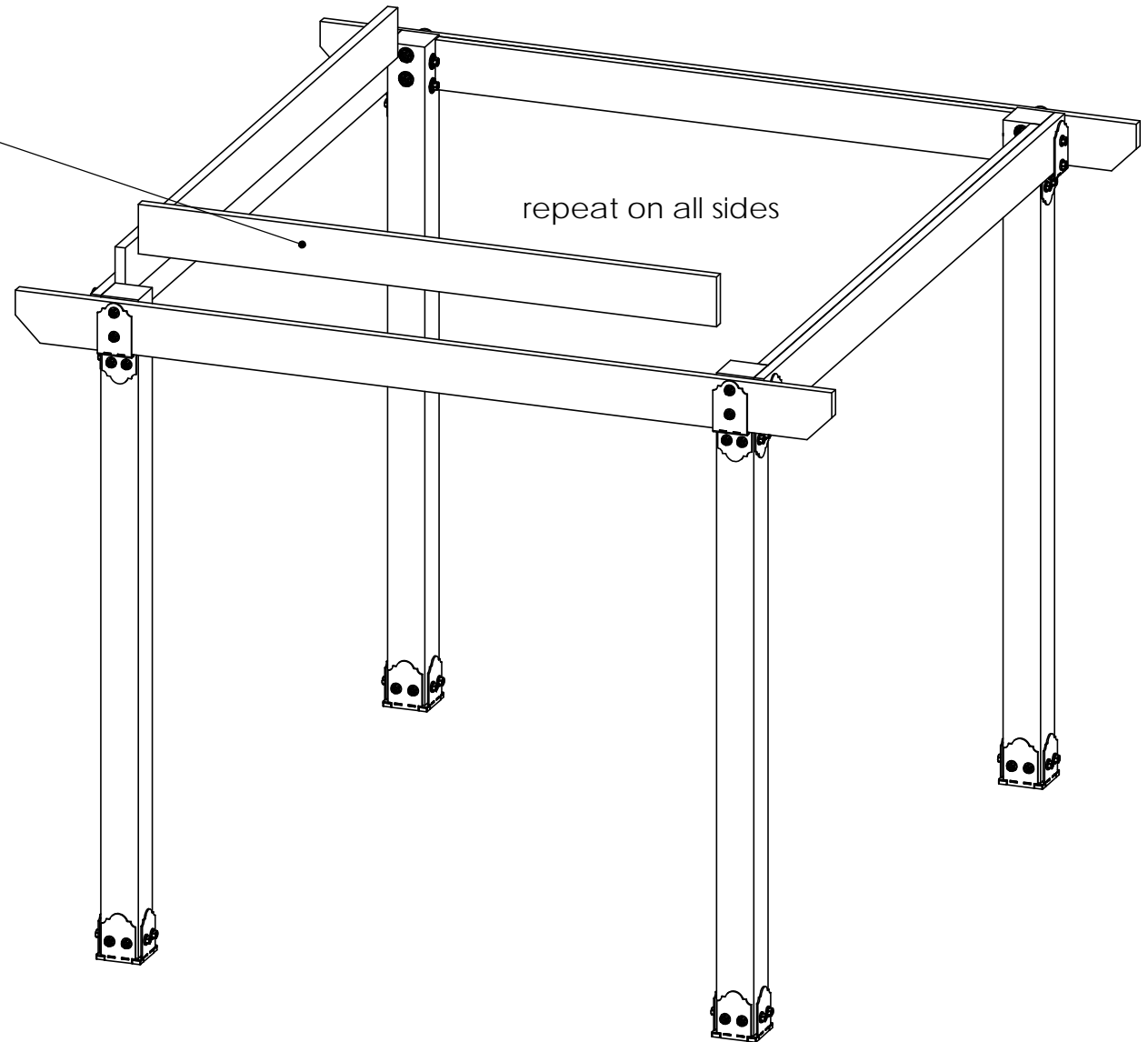

## step 2 Inside Beams

Pavilion Beam & Support

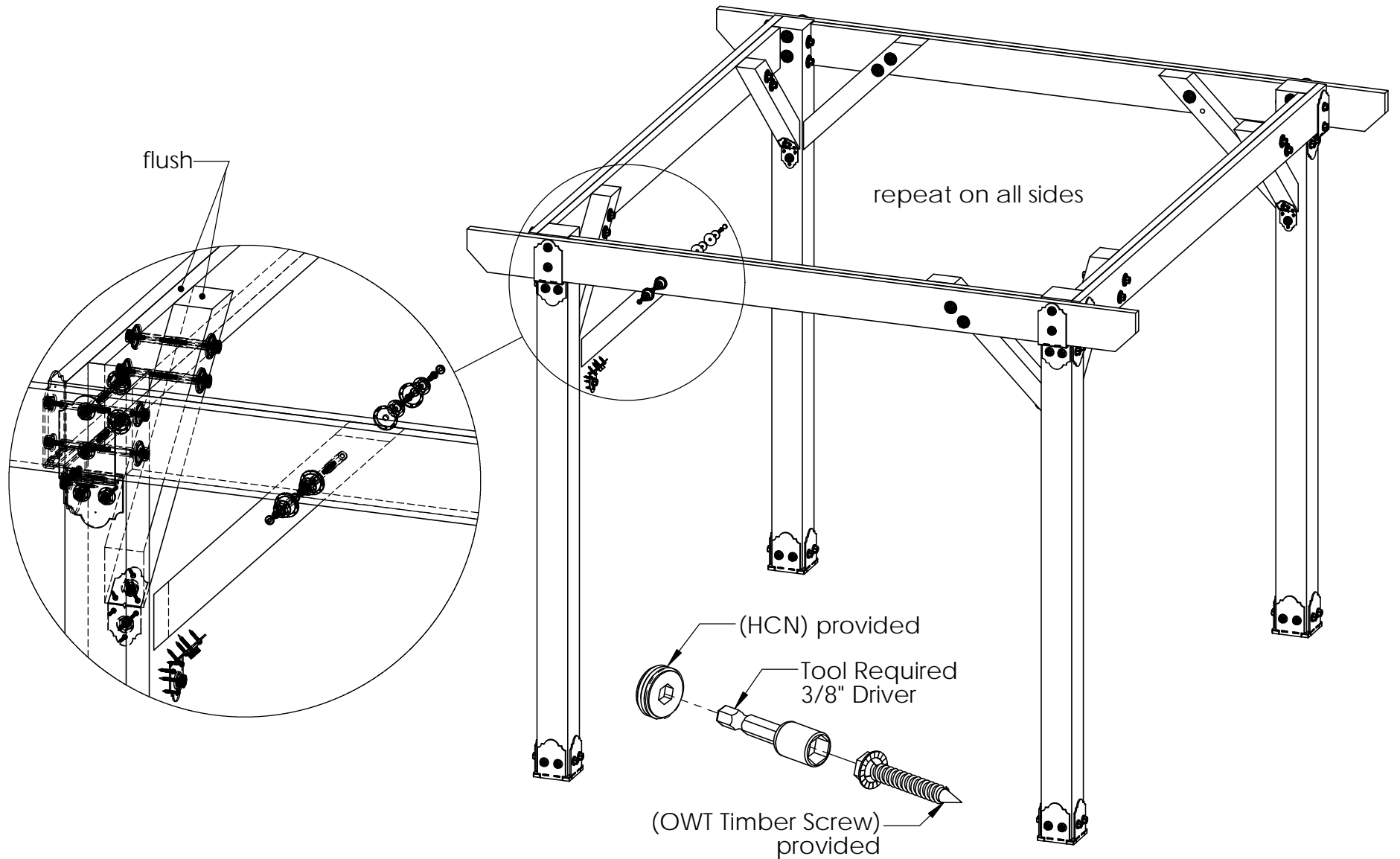

## step 3 Knee Braces

Pavilion Beam & Support

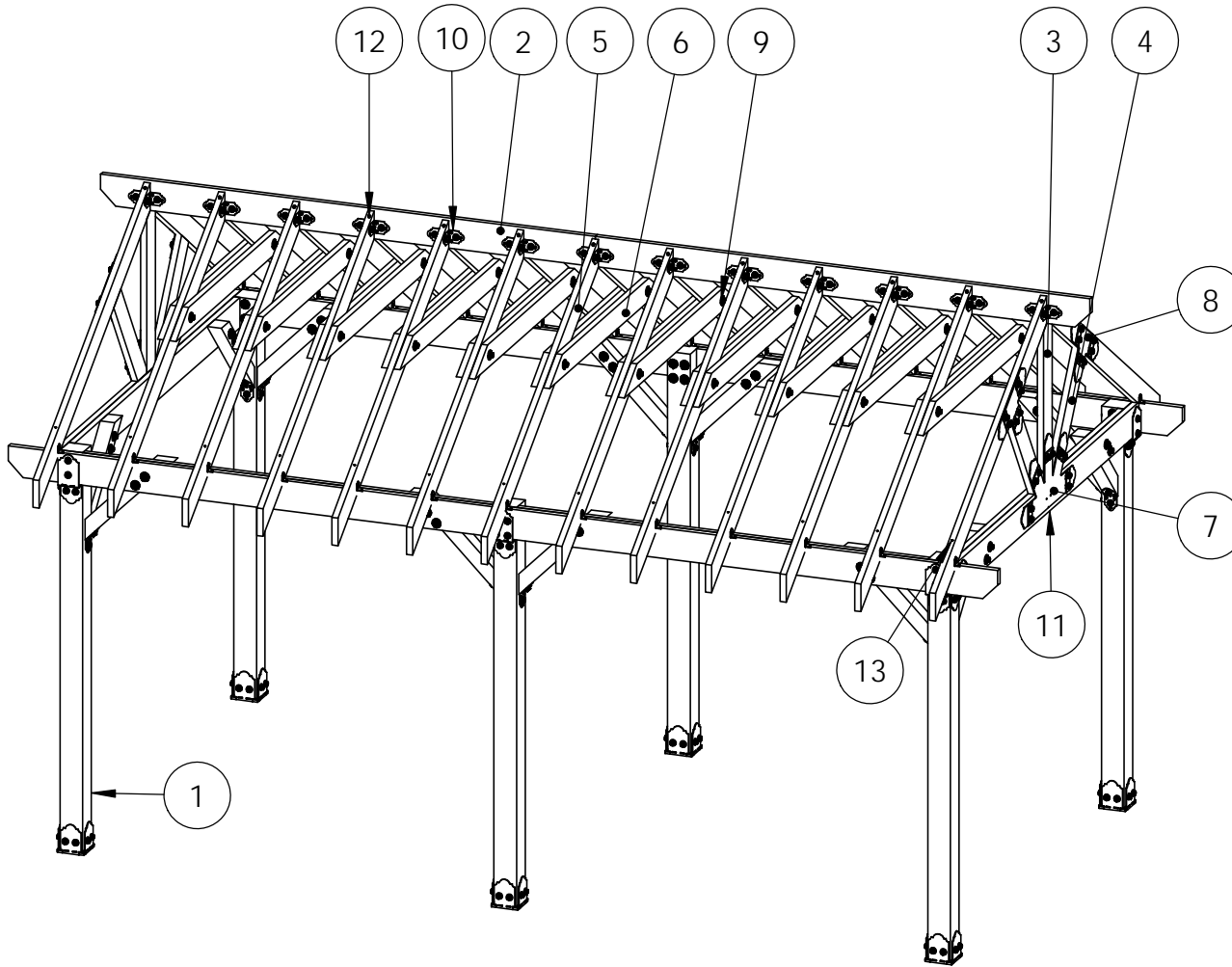

ITEM NO.	QTY.	PART NUMBER	DESCRIPTION
1	1	Pavilion Beam & Support	OZCO Project #209 - 10x20 Pavilion w 6x6 Posts
2	2	2x8 Board	2x8x10'0"
3	2	2x6 Board	2x6x3'2 1/2"
4	4	2x6 Board	2x6x2'6 13/16"
5	26	2x6 Board	2x6x7'5 5/8"
6	22	2x6 Board	2x6x6'0"
7	2	56619	Truss Base Fan 8:12
	5	56611	Truss Accent (TA-LS)
	1	56625	OWT Timber Screw 1-3/4"
8	2	56612	"T" Tie Plate (TTP)
	6	56611	Truss Accent (TA-LS)
	1	56625	OWT Timber Screw 1-3/4"
9	11	56649	OWT Timber Bolt 4-6"
	11	56680	2" Timber Bolt Heavy Duty Washer (OWT-TBW-2)
10	6	56617	2" Standard Rafter Clip (RC-LS-2)
11	1	56647	OWT Timber Screw 10"
12	2	56627	OWT Timber Screw 3-3/4"
13	2	56629	OWT Timber Screw 7-1/2"
14	6	56618	4" Standard Rafter Clips (RC-LS-4)

## OZCO Project #209 - 10x20 Pavilion w 6x6 Posts

Pavilion Truss 10

# Building your Truss... Simple 7 step procedure common to all size Pavilions

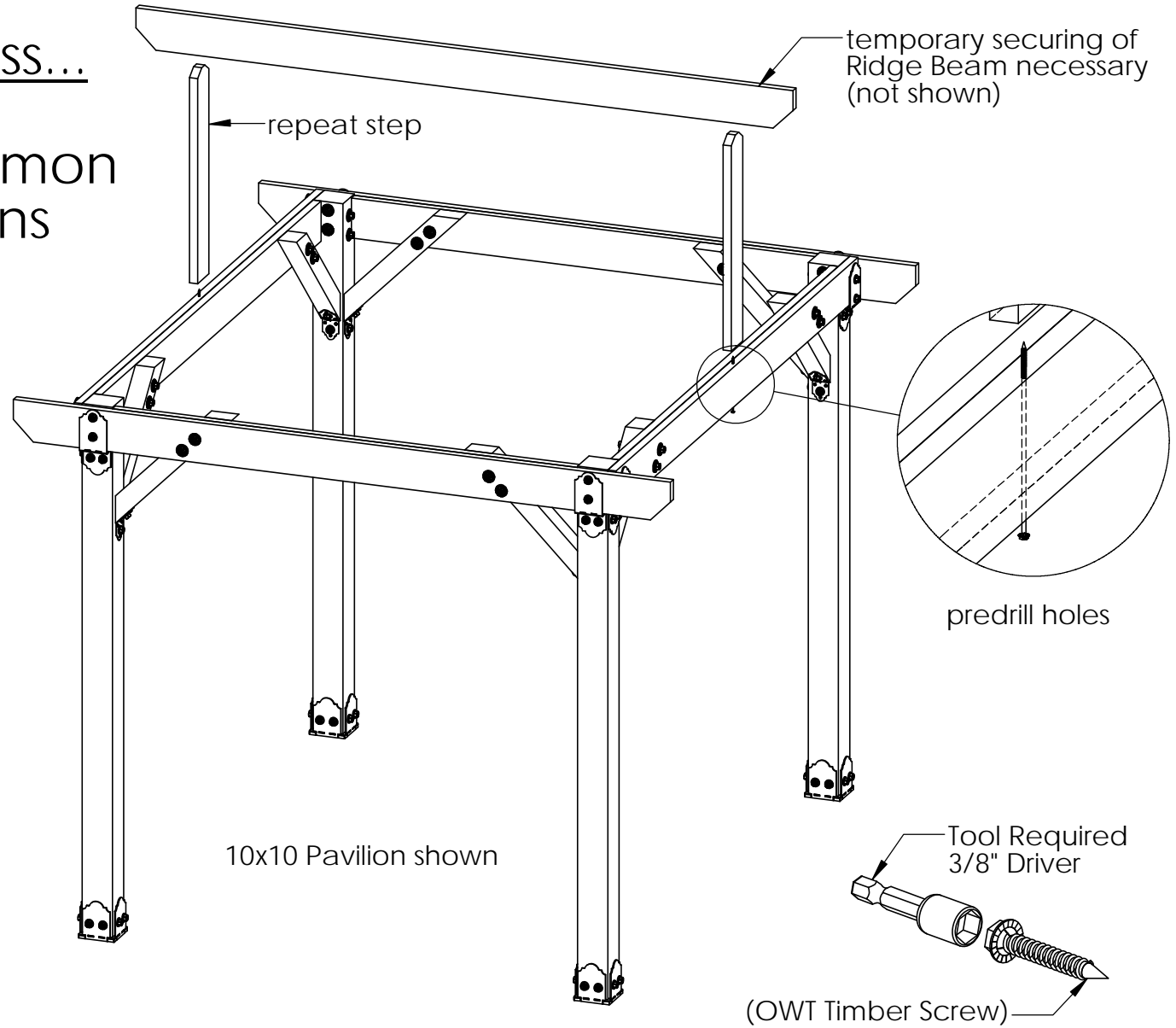

use this procedure for all size Pavilions (10x10 shown). same construction steps and techniques apply

10x10 Pavilion shown

## step 1

### Pavilion Truss 10



repeat step

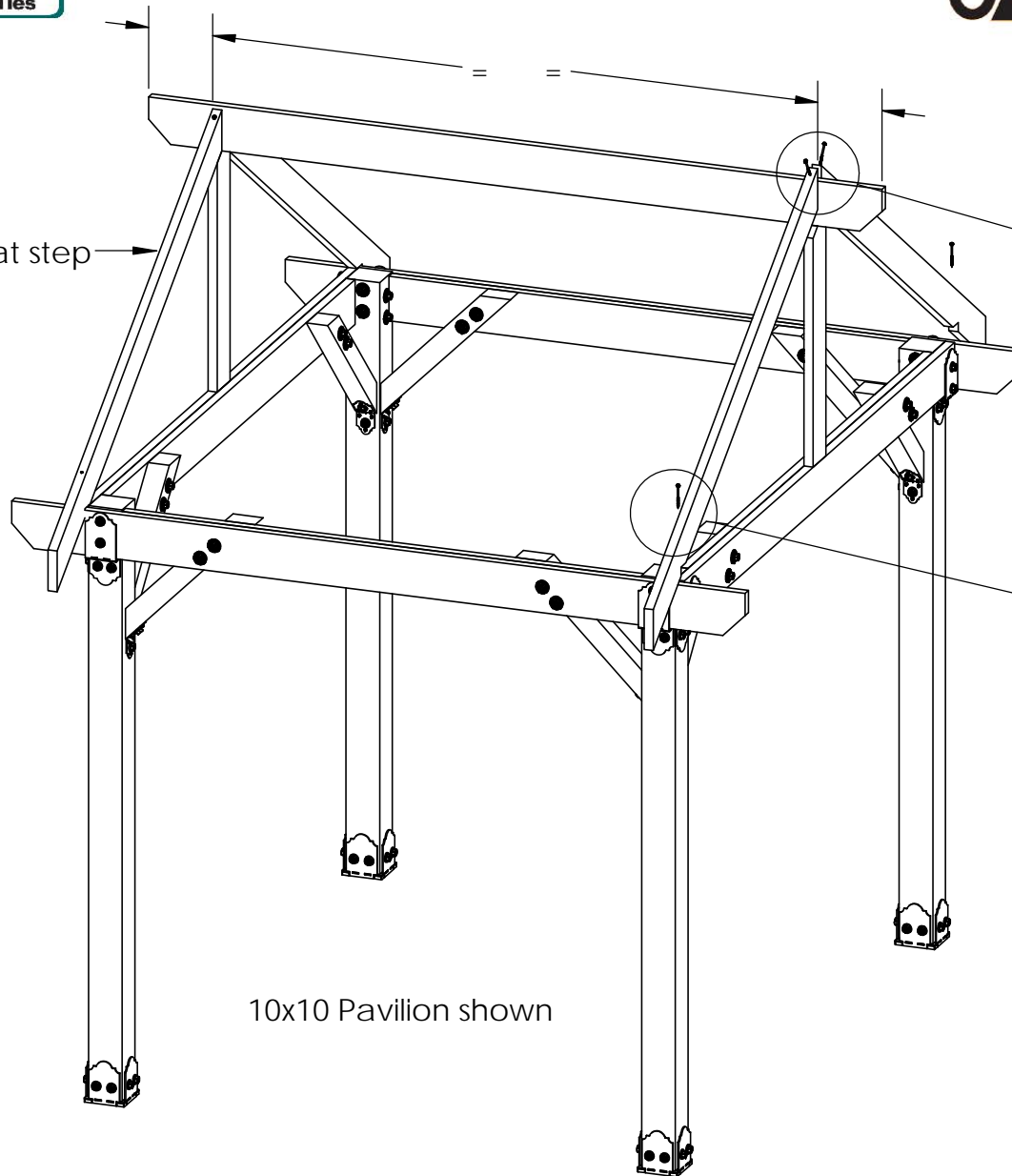

10x10 Pavilion shown

tip: rafter screw heads might interfere with roofing. secure flush/below rafter or modify roofing material as needed.

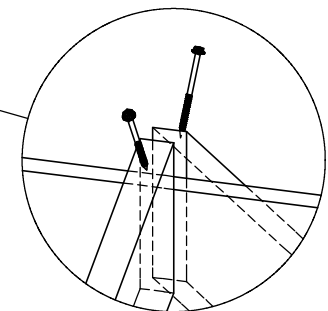

pre-drill holes

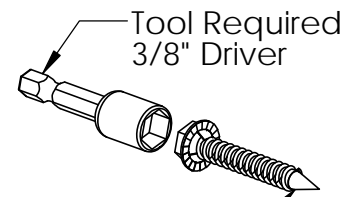
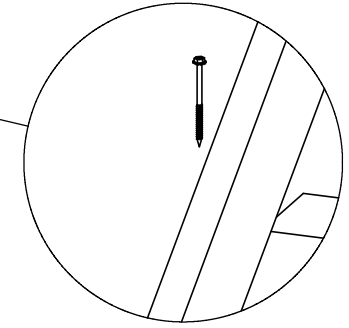

Tool Required  
3/8" Driver

(OWT Timber Screw)

## step 2

Pavilion Truss 10

repeat step 2  
see overview page  
for spacing and  
quantity of Trusses

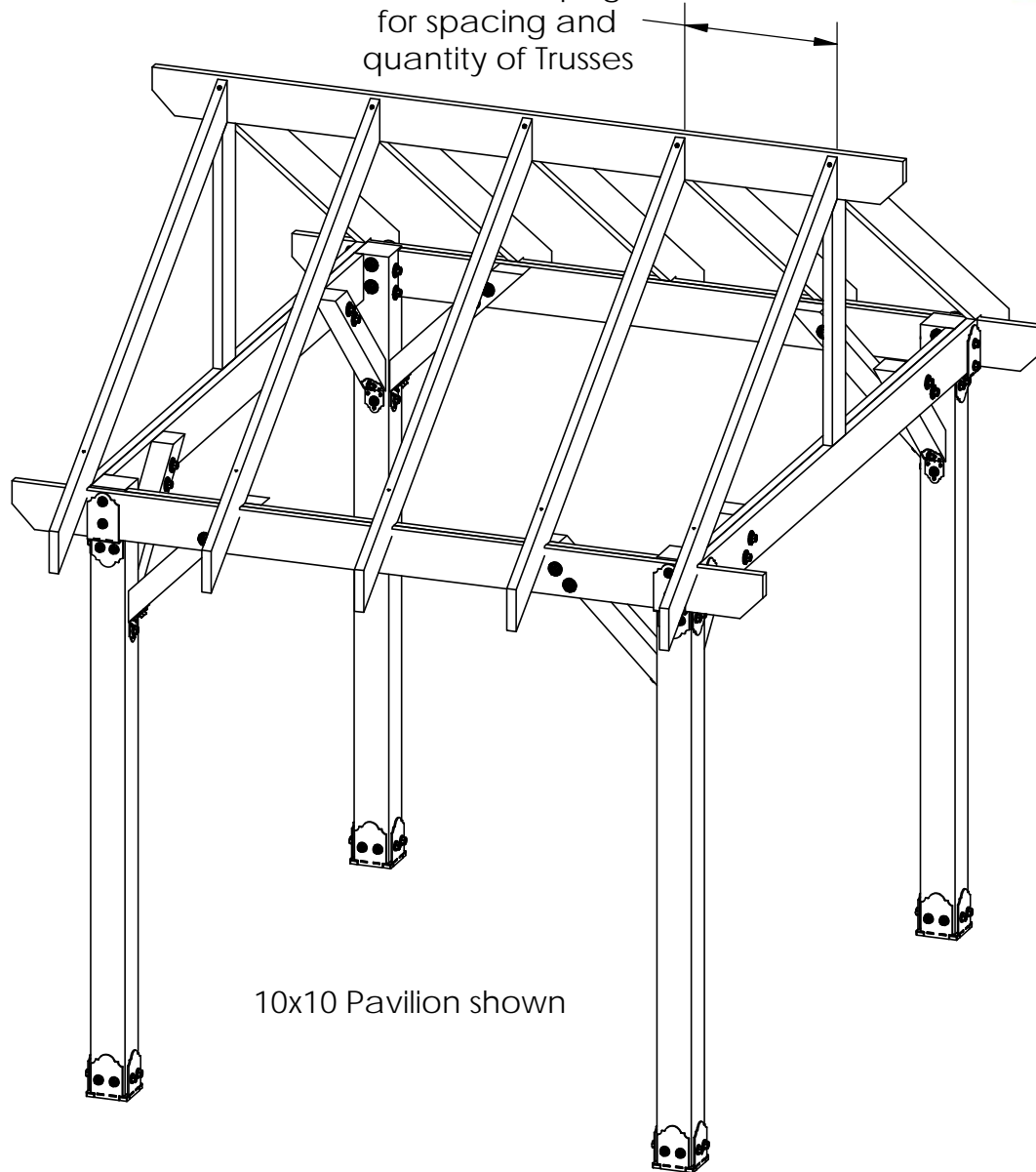

10x10 Pavilion shown

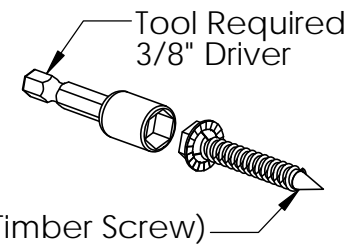

### step 3

#### Pavilion Truss 10

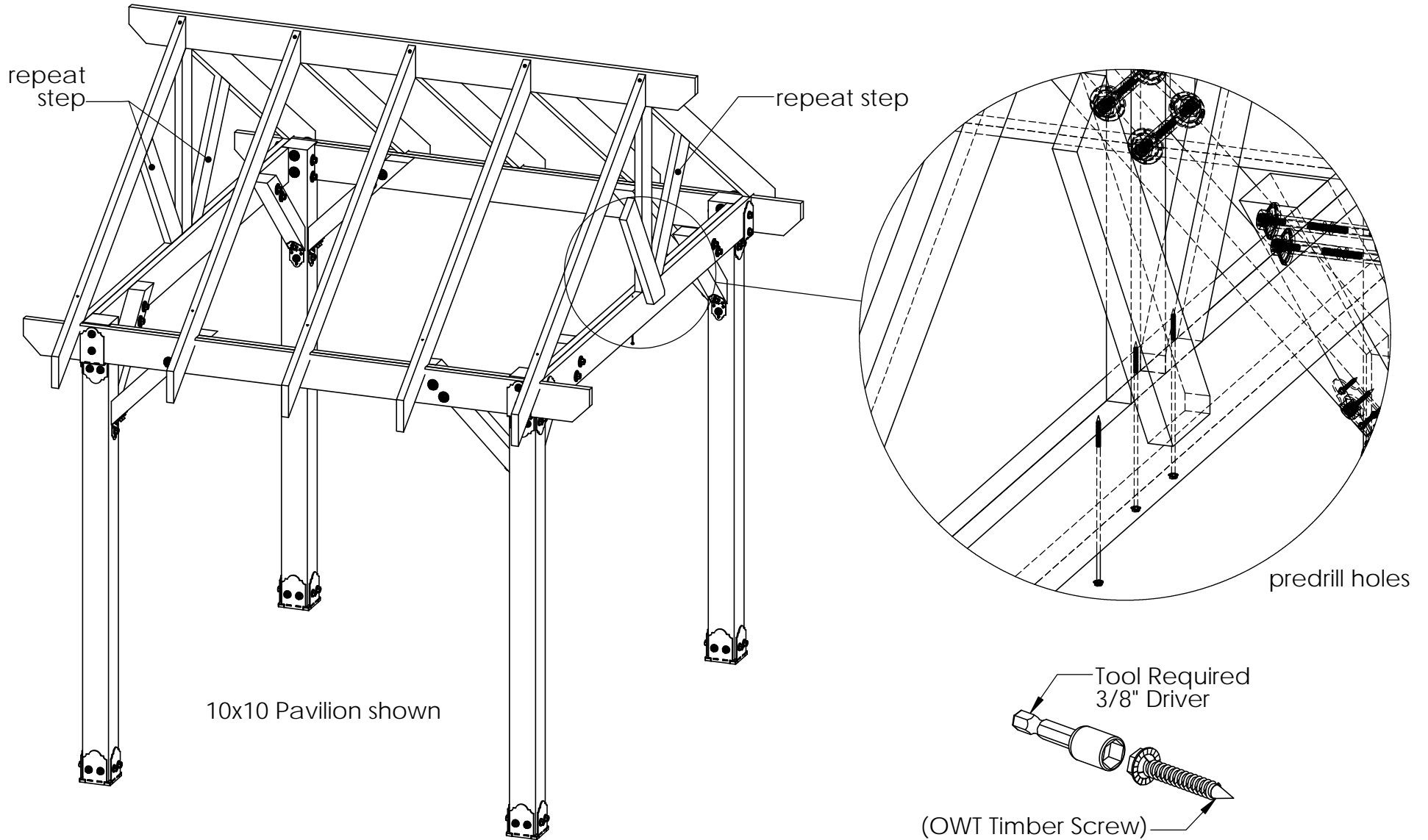

## step 4

### Pavilion Truss 10

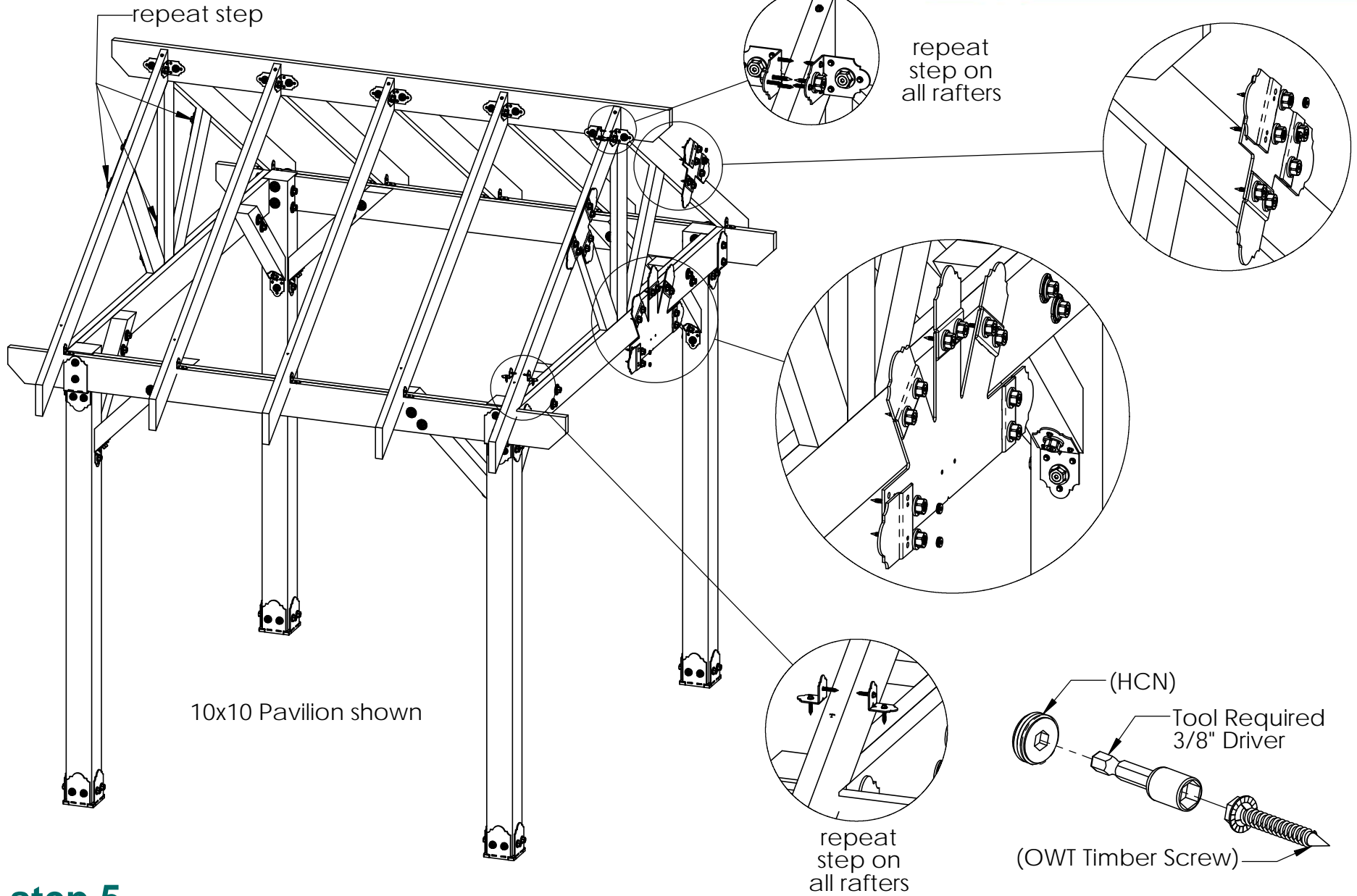

## step 5

### Pavilion Truss 10

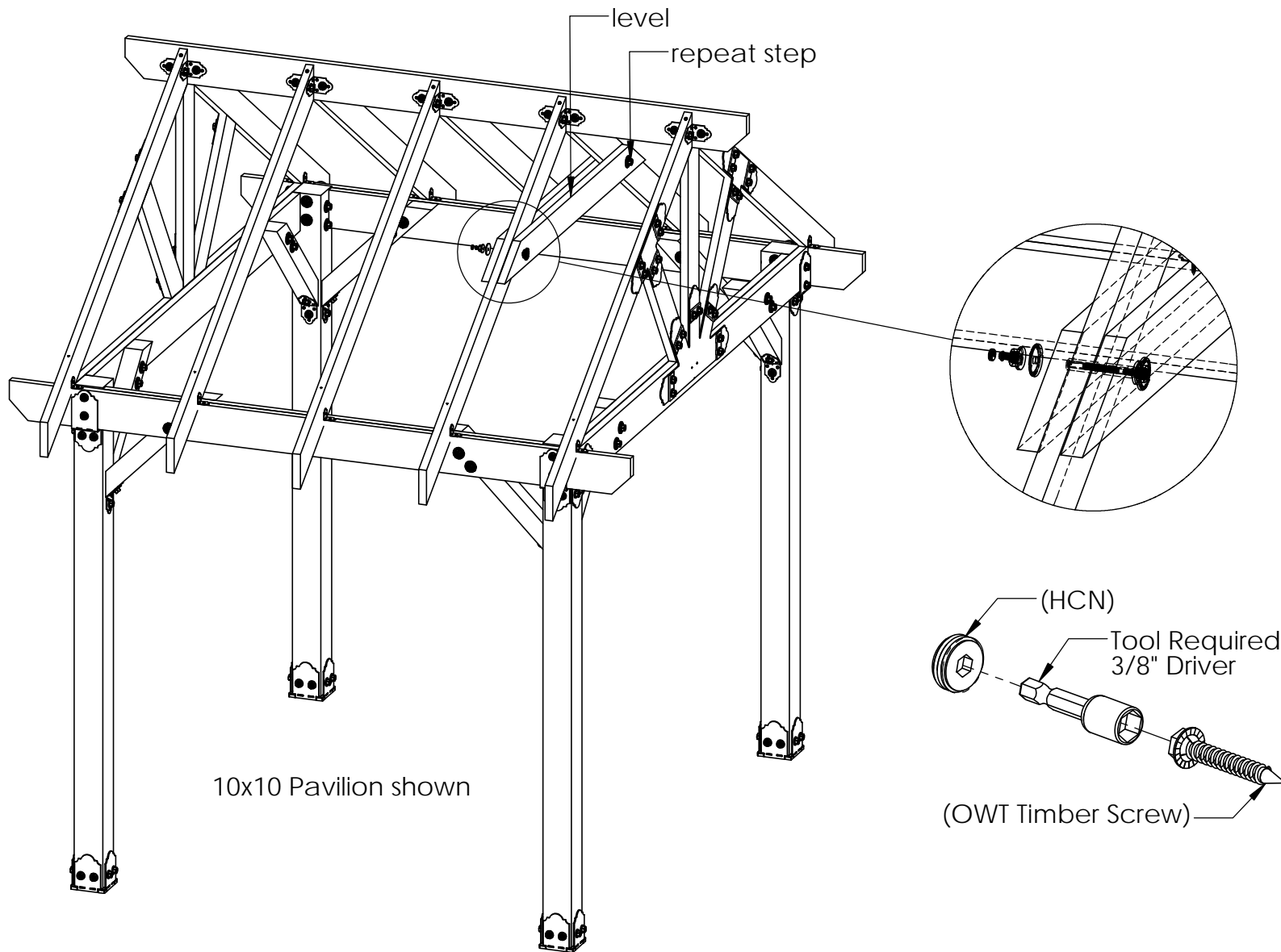

## step 6

### Pavilion Truss 10

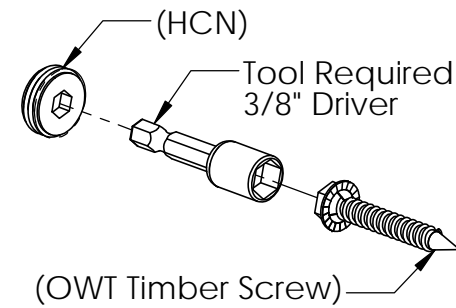
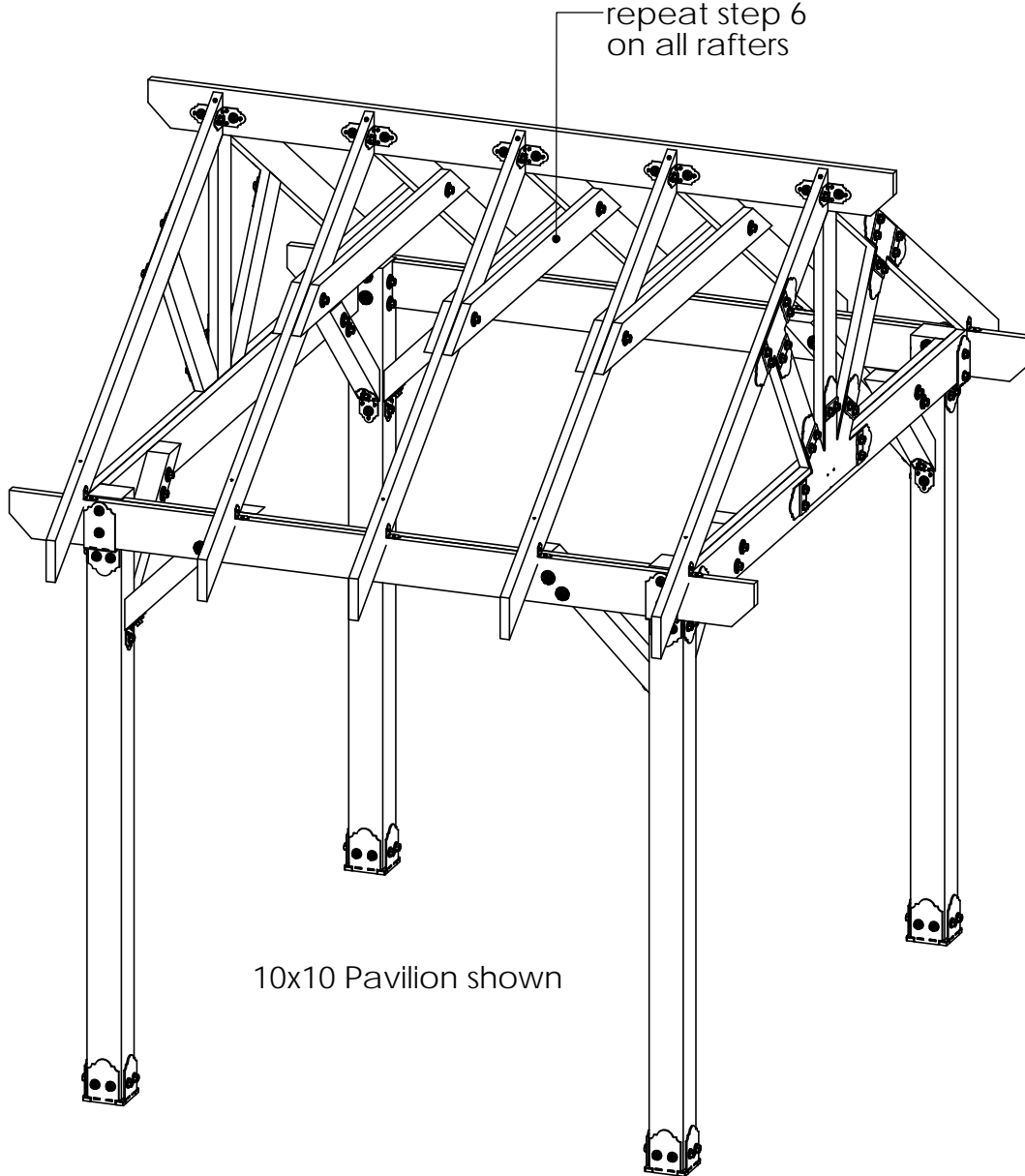

## step 7

### Pavilion Truss 10

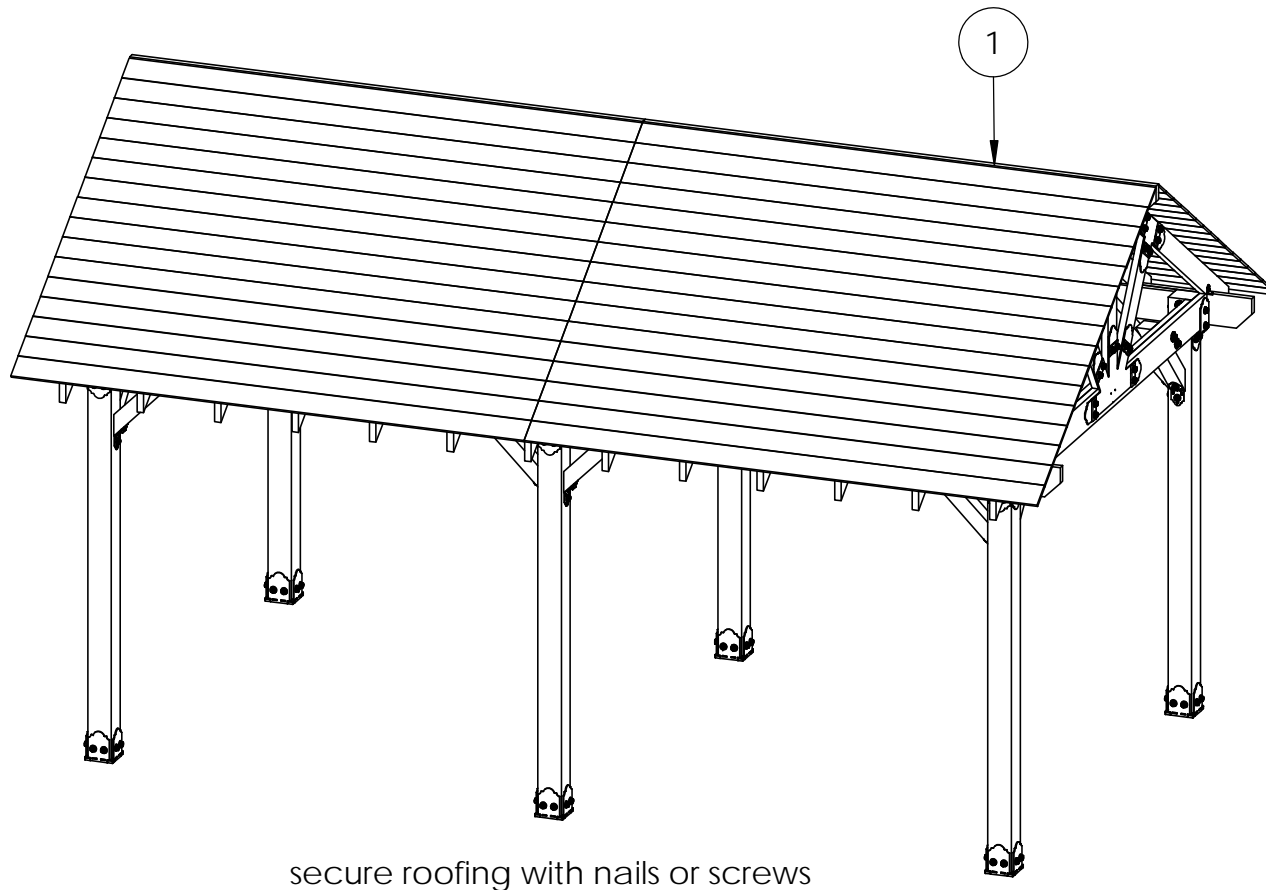

ITEM NO.	QTY.	PART NUMBER	DESCRIPTION
1	64	1x6 Board	1x6x10'0"

## OZCO Project #209 - 10x20 Pavilion w 6x6 Posts Roofed

Pavilion Truss 10 Roofing

V2.00 - Installation Instructions, Specifications and Project Plans are effective 2/21/2017 . This information is updated periodically and should not be relied upon after 2 years from 2/21/2017 . Please visit [OZCOBP.com](http://OZCOBP.com) to get current information.